

WELCOME TO "PEACE AICHI"

More than 70 years have passed since the last war. The number of people who lived through the last war -time period are decreasing. Furthermore, war products, arms, and historical war materials have been rusting, deteriorating, and are being lost. We should pass on historic lessons of the negative legacy, wars in the 20th Century, to future generations. We gathered many wishes of the people to keep peace, and finally established the museum of war and peace, "PEACE AICHI". We want our museum to be a functional facility that teaches the lessons of war, that spreads the citizens' messages of peace, and that plays an important role in relaying the message and this vital education to the next generation. Additionally, we'd be grateful if any visitor to the museum would take the first step to peace.

We hope many people will join us, co-operate with us and assist us.

YOU MAY USE "PEACE AICHI"

Peace Aichi has display sections, an Event Hall, library, and AV corner. Everybody may come and use the library and AV corner. The Event Hall offers mini-concerts, a reading space, meetings and others. Peace Aichi is a communication area for anyone who loves peace. We look forward to your visiting us soon.



PEACE AICHI NEEDS YOUR FINANCIAL SUPPORT

The running costs of Peace Aichi are covered by the membership fees of NPO Memorial Center Preparation Committee members. You are kindly invited to join the NPO committee to offer your support of our project.

■ Regular member (6,000 yen / year)

■ Support member (3,000 yen / year)

※ Regular members are given free admission.

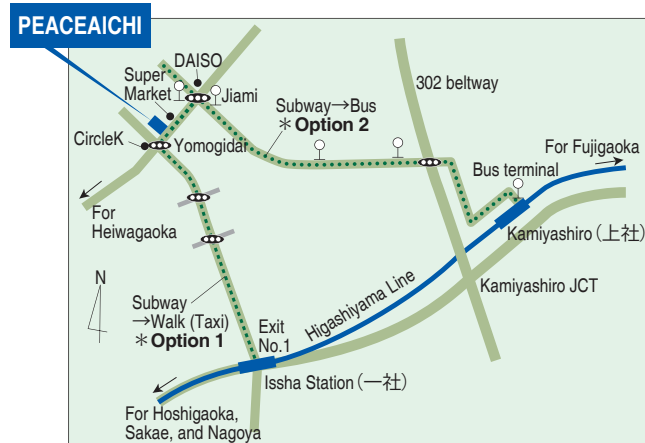

■ Direction

Option 1 : Subway & Walk (Taxi)

Take the Higashiyama Subway Line to Issha Station (一社). From exit no.1, walk north for about 15 minutes.

Option 2 : Subway & Bus

Take the Higashiyama Subway Line to Kamiyashiro Station (上社).

Outside the station, find the bus stop for the loop line (clockwise). And take the bus to Jami (地あみ). Next, walk west for about 3 minutes.



City Buses and Subways, Saturday and Sunday Eco Tickets
Any visitor who buys an Eco Ticket for use on the public transportation will be offered a discount upon admission.
Adults 300 yen →250 yen
Primary/high school students 100 yen →80 yen

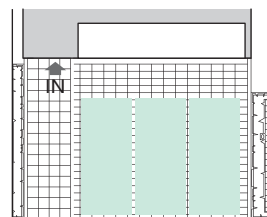

GUIDE FOR PARKING

There are 3 parking spaces available. Please contact the desk for location.
Cost: 300 yen per day.

War and Peace Museum PEACE AICHI



War and Peace Museum PEACE AICHI

〒465-0091 2-820 Yomogidai, Meito-ku, Nagoya

TEL • FAX 052-602-4222

- open Tuesday ~ Saturday (including national holidays)
11am ~ 4pm
- closed Sunday • Monday • Summer and around the End /
New Years' holidays
(We will be open for pre-reserved groups.)
- admission Adults 300 yen primary • high school students 100 yen

War and Peace Museum, PEACE AICHI, has been established and organized by the War Memorial Center Preparation Committee.

Home page <http://www.peace-aichi.com/>

● DISPLAY OF EACH SECTION

The first display section AIR RAIDS OVER AICHI PREFECTURE



Aichi prefecture was terribly bombed and devastated during the last war. Do you know how our cities, towns, houses and streets were devastated? Do you know why people suffered from such severe air raids? We condemn any air raids which are still being conducted anywhere in the world by showing the photos and exhibits of air-raids in this museum. We are strongly opposed to the ideology of air-raids and other atrocities.



The second display section WHOLE VIEW OF THE WARS & 15-year- War

On the wall panels the invasion routes of the Japanese Imperial army/navy and many battles and conflicts during the fifteen-year-war are shown in historical order with maps, photos and detailed comments/illustrations.

"The photos of the slain victims in the Fifteen-Year-War", hung in the center of the display section, are our "life wall panel". We regard the policy of conducting wars as the destruction of human dignity. Peace and War Museum Peace Aichi always promotes our essential main theme as "war•life•death"



AUDIO•VIDEO CORNER (2nd floor)

Videos of the Wars in Showa are shown.



THE PICTURE "WAR RUINS" (2nd floor)

Mr. Toyoji Kojima, an artist who paints in a Western style, painted the building of the head-quarters of the Aichi Clock Electricity Corporation in 1957 when he was a high school student. The building and plant factories were heavily bombed during the last war, and thousands of mobilized students were killed.



Exhibition for pupils and students (3rd floor)

"The exhibition of the animals during the war", During the war time many animals in the zoos of Japan were killed because of disease and the shortage of food. However, an elephant of the Higashiyama Zoo was kept well and survived. After the war, many children across Japan came by train to see the elephant.

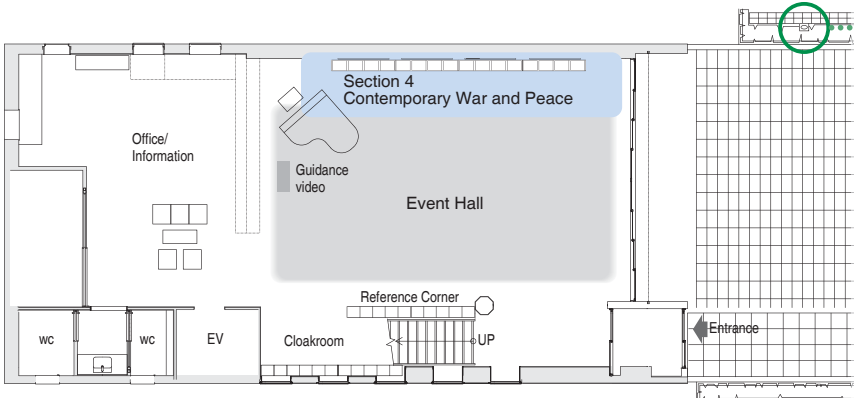

First Floor

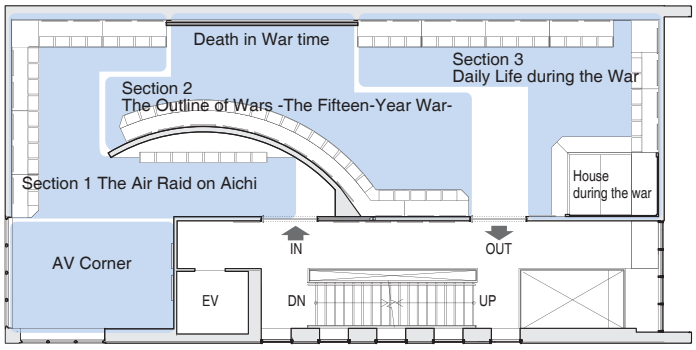

Second Floor

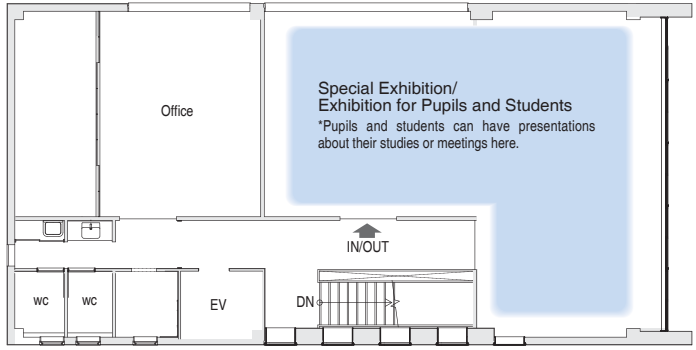

Third Floor

PEACE JIZOU

We welcomed the Peace Jizou (Buddhist statue) which watched the over casualties of the war and devastated area at Chihaya, Naka-ku, Nagoya for a long time. Now the Peace Jizou is with us at Peace Aichi.

The third display section DAILY LIFE DURING THE WAR

How did the people live during the 15-year-War period? What do they answer when their children who have no war experience ask them the question? To answer these questions, we recall those days and display a typical war-time family living room with old but real furniture/lights.



The fourth display section MODERN WAR AND PEACE

Though more than 70 years have passed since the end of World War II, we still have some conflicts around the world. Everybody loves peace and wishes to live in a peaceful world. However, wars never end. How can we approach the final ultimate desire? By viewing such exhibits as these, we can consider various aspects of war and peace.

